



PurePro[®] POSEIDON



REVERSE OSMOSIS SYSTEM
USER'S MANUAL



PUREPRO
DRINKING WATER SYSTEM

© PUREPRO USA CORP., ILLINOIS, U.S.A.

Thank you very much for selecting Pure-Pro Water Corp.
In order to bring the best use of your system, please read the user's
manual carefully before installation and follow the regulations.



System overview



■ Poseidon PRO
■ Poseidon LUXURY



■ Poseidon ELITE



Stage 1 / Service Life : 6-12 Months
With only five micron rating. It is effective in removing dirt, rust and sand particles.



Stage 2 / Service Life : 6-12 Months
It takes out 99% of the chlorine and organic chemicals. It provides enhanced reduction of taste, odor, and color.



Stage 3 / Service Life : 6-12 Months
It takes out 99% of the chlorine and organic chemicals. It provides enhanced reduction of taste, odor, and color.



TFC Membrane

Stage 4 / Service Life : 2 Year

A thin film composite (TFC) high quality membrane that processes 100 gallons per day. It remove the following hard water contaminants that may be present in your water: lead, copper, barium, chromium, mercury, sodium, cadmium, fluoride, nitrite, nitrate, and selenium.



Mineral Filter

Stage 5 / Service Life : 6-12 Months

This filter improves the qualities of clean water by adding necessary for proper human development and health minerals, such as Calcium, Magnesium, Sodium, Potassium and others readily found in many natural mineral waters.



Alkaline Filter

Stage 6 / Service Life : 6-12 Months

The Alkaline filter boosts the PH of the RO water into a perfect Natural Alkali Calcium Ionized Water. The Alkaline filter also gives back minerals such as ionized calcium, magnesium, sodium, potassium ion, which were taken away while purifying the water.



Far-Infrared Filter

Stage 7 / Service Life : 6-12 Months

This Infra-Red filter can activate water molecules in our body and improve oxygen levels in our body. Warming and eliminating fats, chemicals and toxins from our blood and thus smoothening the flow of blood.



Ultraviolet Sterilizer
(Optional)

Stage 8 / Service Life : 6-12 Months

Ultraviolet light (UV), a natural part of the sunlight is widely accepted as a reliable, efficient & environmentally friendly solution for water disinfection. This UV lamp utilize the application of particularly efficient UV radiator with a 254nm wave length to cause immediate death for organisms and wipe out their ability to survive and reproduce.
99.99% DESTRUCTION OF BACTERIA AND VIRUSES

Components

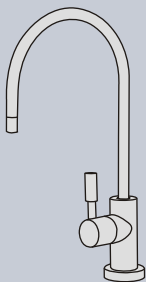

Euro-Luxury faucet
(Poseidon PRO / LUXURY)

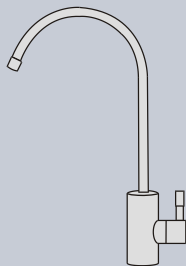

European ceramic faucet
(Poseidon ELITE)

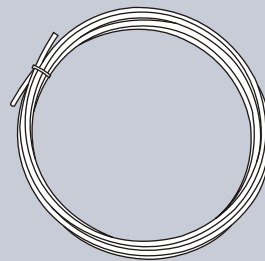

Tubing

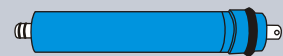

RO / ECO Membrane

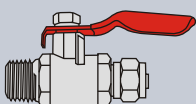

Deliver-valve

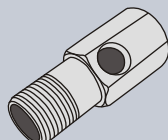

Water supply connector

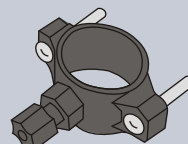

Drain saddle

Tubing connection diagram

■ Connecting the color tubing

- A. Connect the WHITE tubing to the water supply connector.
- B. Connect the BLUE tubing to the countertop faucet.
- C. Connect the BLACK tubing to the drain saddle.



【 Back view 】

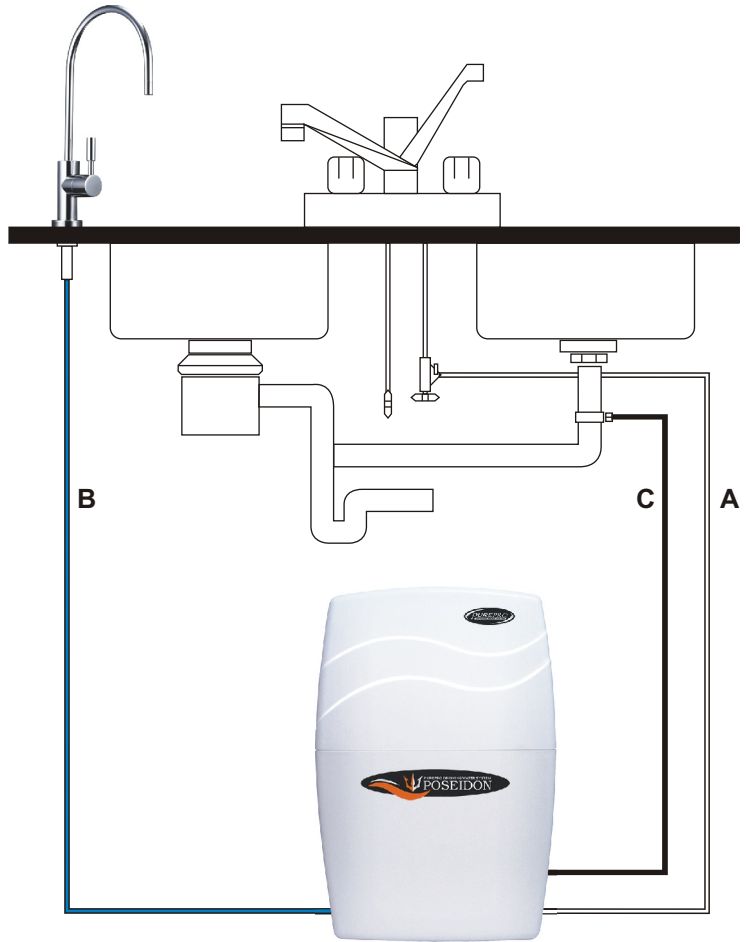

Installation diagram

Input water :

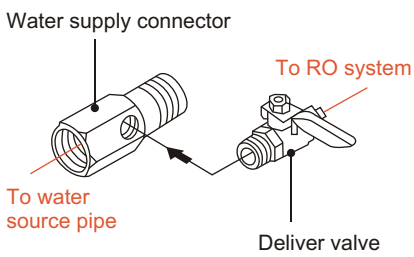

Install membrane :

- Remove the tube.

- Remove the membrane housing cap.
- Install the membrane by carefully pushing the spigot end into the socket at the far end of the housing until completely in.

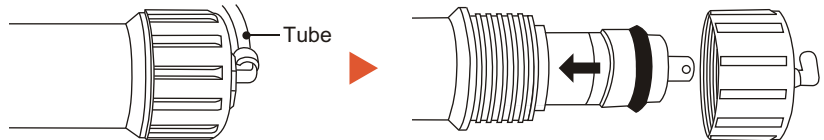

Install drain saddle :

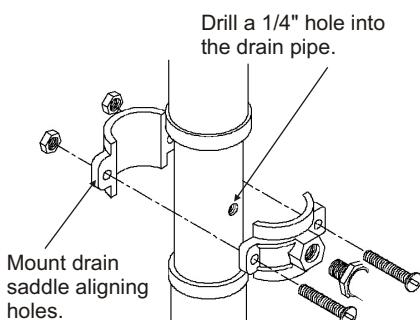

Install faucet :

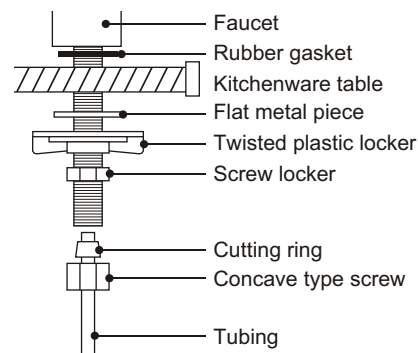

Installation diagram

1. Turn off the water supply. Loosen the stainless steel pipe connector. Get feed water connector and connect it to the stainless steel pipe.

1

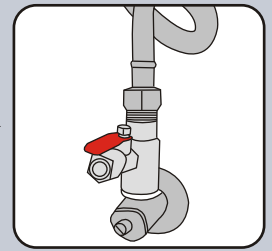
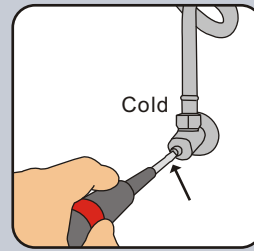

2. Get tubing white, connect it with deliver valve and the inlet water supply.

2

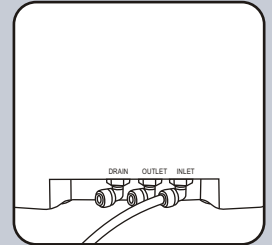
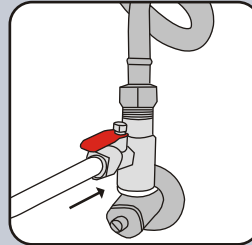

3. Take tubing black, connect it with the drain out.

3

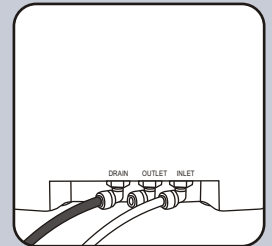
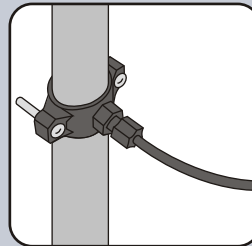

4. Use an electric drill and drill an approximately 1 cm hole through the kitchenware table. Take out the faucet and its components. Install the faucet and the rubber gasket to the kitchenware table. Take tubing blue. Wear the concave type screw on tubing blue and insert the tubing shroud as shown in the picture. Connect the tubing top with the faucet end. Then connect the tubing end to the hole of "TO FAUCET".

4

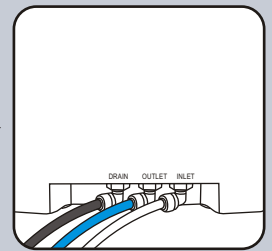
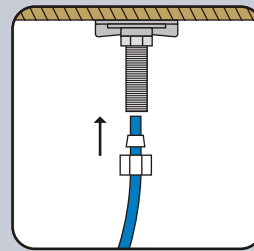

5

5. Make sure that you complete. If so, switch on water supply and plug in electricity.

PS. Do not use drink water from the first made water in the tank.



Change filters

Change stage 1, 2, 3

- 1 Before filter replacement, please make sure water and electricity supply are cut off. Please turn off the tank ball valve, too.
- 2 To loosen filters, turn and rotate clockwise.
- 3 To tighten filters, turn and rotate anti-clockwise.

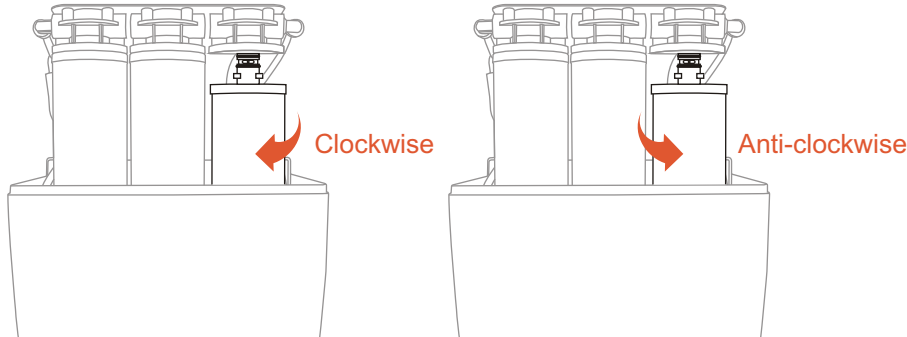

Change stage 5, 6, 7, 8

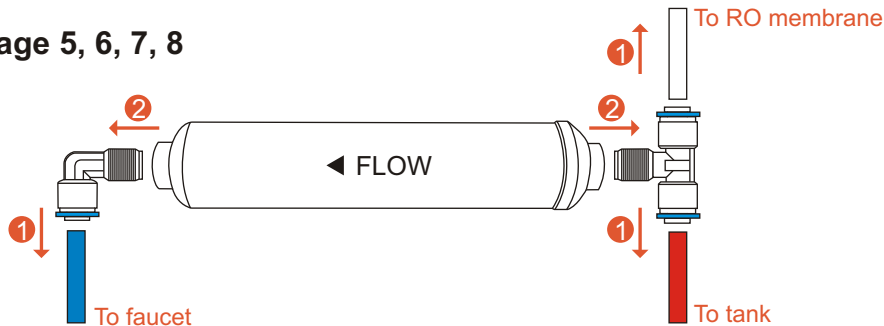

- 1 Before filter replacement, please make sure water and electricity supply are cut off. Please turn off the tank ball valve, too.
- 2 Filters carry direction of water flow. Please make sure the correct flow direction during installation.
- 3 Loosen the quick fitting on both ends to replace the filter.
- 4 To avoid leakage, please tighten the quick fitting with Teflon tape before filter replacement.

Change RO / ECO membrane

Change stage 4

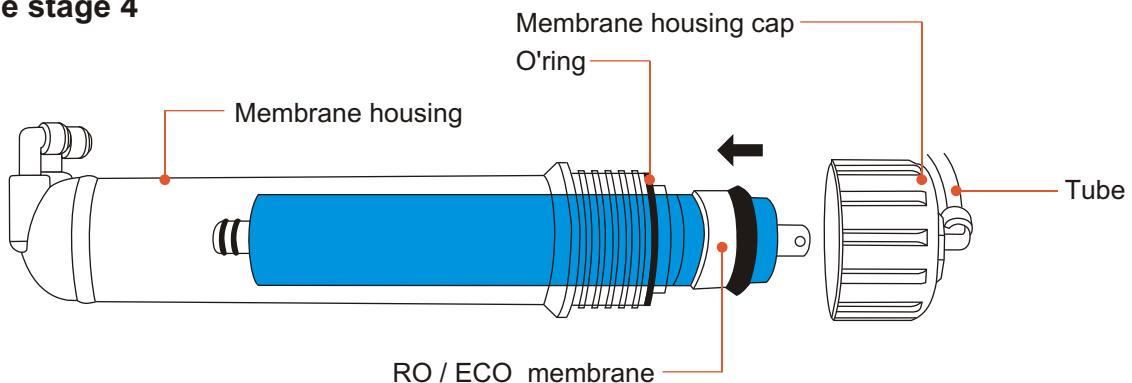

- 1 Before filter replacement, please make sure water and electricity supply are cut off. Please turn off the tank ball valve, too.
- 2 Remove the tube.
- 3 Remove the membrane housing cap anticlockwise.
- 4 Remove the membrane by a pincer.
- 5 Install the membrane by carefully pushing the spigot end into the socket at the far end of the housing until completely in.
- 6 Be sure tighten with O-ring to prevent from leaking.

※ After changing filters, let water run for about 15 minutes to clear the filters.

Operation regulation

- A. With everything connected, turn on the water check for leaks.
- B. Make sure the storage tank shut-off valve is "OFF". Open the sink top faucet.
- C. Within a few minutes (up to 15) the water will start to run from the faucet slowly.
- D. Let the water run for at least 30 minutes. This flushes the carbon filters on first time use.
- E. After initial flushing, open the shut-off valve on the tank and close the sink top faucet.
- F. Tank will now full of water (usually 2 to 3 hours) after the tank has filled.
Open the sink top faucet and drain all water until the storage tank is empty and there is only a small flow from the sink top faucet. *** DO NOT USE FIRST TANK OF WATER.***
- G. Close the sink top faucet. The system is now ready for use.
- H. Change filters regularly every 6 to 12 months and have the membrane checked annually.

Caution

1. Do not use hot water (over 45°C)!
2. Do not freeze the machine!
3. Switch off electricity and water source if away for more than 5 days, and drain out pure water.

Warranty

Type of product			
Date of purchase			
Name		Tel	
Address			
★ If the supply cord is damaged, it must be replaced by a special cord or assembly available from the manufacturer or its service agent.			

Pure-Pro Reverse Osmosis (RO) Systems

Over ten years expertise in reverse osmosis drinking water systems, our unique design features make installation easier and operation more reliable, and our wide selection of colors and sizes allows you to solve virtually any RO application.

PUREPRO
DRINKING WATER SYSTEM

© PUREPRO USA CORP., ILLINOIS, U.S.A.

Pure-Pro Water Corporation

19636 S. 97th Ave Mokena, Illinois, U.S.A.

Tel: +1 708 479 4473 Fax: +1 708 479 4332

 www.purepro.net